

2.0 HOCKINSON SCHOOL DISTRICT PROFILE:

2.1 District Location

The Hockinson School District is comprised of three schools and one District Office. We are located in Brush Prairie, which is in unincorporated Clark County, WA.

Figure 2.1
Hockinson School District Map

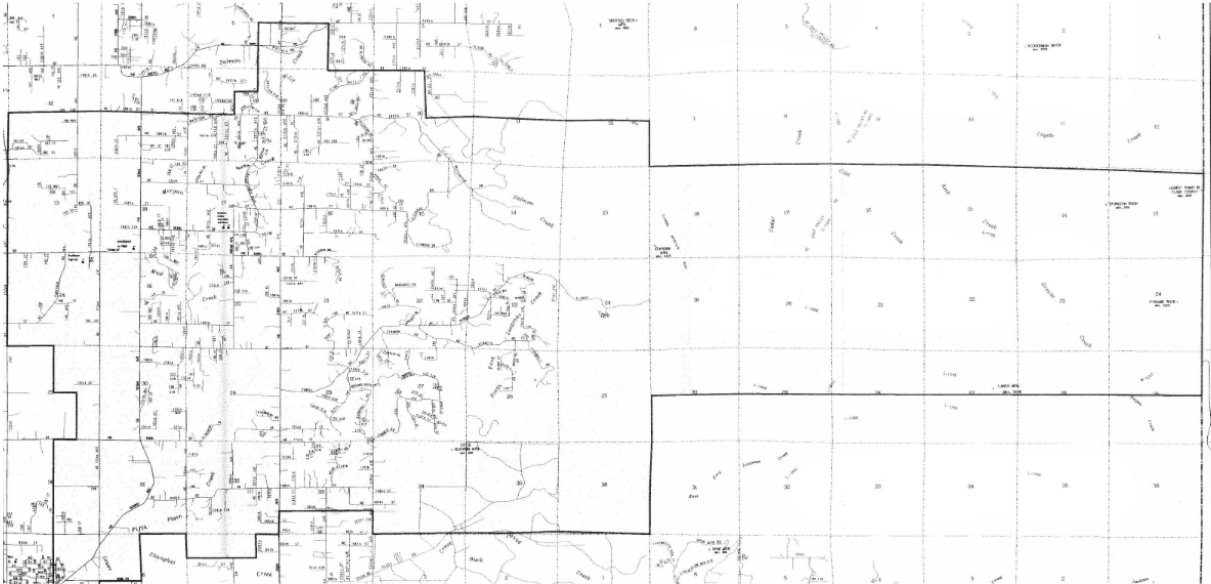

The total population within the district's boundaries is approximately 8,710 based on the Census 2010 data.

Figure 2.2
Hockinson School District and Vicinity



2.2 District Overview

Hockinson Schools were established by Scandinavian immigrants in the late 1870's. The original school house was sited where the present day Middle School is located. An Elementary School was added on the east hill and finally a High School was built in 2003. Hockinson High School's first graduating class was in 2006 after many years of being a non-high school district.



Hockinson Middle School



Hockinson Heights Elementary School
(formally Hockinson Heights Primary and Intermediate School)



Hockinson High School

The Mission of Hockinson School District is:

To collaborate toward our common purpose.

To challenge our assumptions by continually evaluating and improving.

To use effective and relevant instructional practices to improve student learning.

To maximize available resources.

To help everyone in the organization to become the best at what they do.

To provide a safe and healthy environment.

To raise awareness and encourage the community to become active participants.

September 2016

Hockinson School enrollment counts as of are as follows:

Hockinson Heights Elementary School: 755

Hockinson Middle School: 425

Hockinson High School: 667

The District has a small preschool and a Community Education program which currently offers an afternoon program for younger students.

The District employs 207 regular employees that includes Administrative staff, Teachers & Specialists, and Classified staff.

Student Demographics		
Enrollment		
October 2015 Student Count		1,874
May 2016 Student Count		1,865
Gender (October 2015)		
Male	967	51.6%
Female	907	48.4%
Race/Ethnicity (October 2015)		
Hispanic / Latino of any race(s)	87	4.6%
American Indian / Alaskan Native	8	0.4%
Asian	44	2.3%
Black / African American	13	0.7%
Native Hawaiian / Other Pacific Islander	1	0.1%
White	1,671	89.2%
Two or More Races	50	2.7%
Special Programs		
Free or Reduced-Price Meals (May 2016)	346	18.6%
Special Education (May 2016)	175	9.4%
Transitional Bilingual (May 2016)	36	1.9%
Migrant (May 2016)	0	0.0%
Section 504 (May 2016)	69	3.7%
Foster Care (May 2016)	N<10	
Other Information (more info)		
Unexcused Absence Rate (2015-16)	575	0.3%
Adjusted 4-Year Cohort Graduation Rate (Class of 2015)		92.7%
Adjusted 5-year Cohort Graduation Rate (Class of 2014)		92.1%
<u>College/University enrollment rates of graduates</u>		

Demographic data is often included in mitigation plans, especially in the context of evacuation planning and for communication, education, and outreach efforts.

**Table 2.1
Selected Demographic Data
Clark County**

People QuickFacts	Clark County	Washington
Population, 2014 estimate	451,008	7,061,530
Population, 2013 estimate	443,312	6,973,742
Population, 2010 (April 1) estimates base	425,363	6,724,543
Population, percent change - April 1, 2010 to July 1, 2014	6.0%	5.0%
Population, percent change - April 1, 2010 to July 1, 2013	4.2%	3.7%
Population, 2010	425,363	6,724,540
Persons under 5 years, percent, 2013	6.5%	6.4%
Persons under 18 years, percent, 2013	25.6%	22.9%
Persons 65 years and over, percent, 2013	13.2%	13.6%
Female persons, percent, 2013	50.6%	50.0%

Following is a list of additional online resources with demographic information to assist your planning effort:

Washington State Office of Financial Management (links to various data sources):
<http://www.ofm.wa.gov/localdata/default.asp>

US Census (county specific data):
<http://quickfacts.census.gov/qfd/states/53/53031.html>

Washington State Report Card (school district specific data):
<http://reportcard.ospi.k12.wa.us/Summary.aspx?year=2012-13>

2.3 District Facilities

The Hockinson School District has 3 campuses and several other facilities including a district office building and maintenance building.

**Table 2.2
District Facilities
Hockinson Pre-Disaster Mitigation Summary**

Hockinson Pre-Disaster Mitigation Summary						
Campus/ Building	Building Condition	Floors	Building Area	Built	SqFt	Structural Sys
Hockinson Heights Elementary School (East)						
Building 100 A	81.25% Fair	1	10	1992	0	W1
			10	1992	0	W1
			4	1992	0	W1
			5-6	1992	0	W1
			7	1992	0	W1
			8	1992	0	W1
			8	1992	0	W1
			9	1992	0	W1
			Area 1	1992	5,898	W1
			Areas 2-3	1992	7,317	RM1L
Building 200 C	80.94% Fair	1	New	1992	10,630	W1
			Area 15	1975	0	W1
			Area 16	1975	0	W1
			Areas 13, 14-17	1975	6,378	W1
Building 300 D	87.17% Good	1	Areas 15	1992	7,556	W1
			Areas 18 & 19	1975	5,546	W1
			Areas 20 & 21	1992	4,608	W1
Building 400 B	87.78% Good	1	Areas 11-12	1992	3,982	W1
Building 500 E	86.73% Good	1	1	1980	6,729	W2
			2	1980	764	W1
			3	1980	1,584	W1
			4,5	1980	1,014	W1
Building 600 F	85.91% Good	1	6,7,11,12	1980	656	W1
			8,10	1980	4,598	W1
			9	1980	0	W1
Building 700 G	87.27% Good	1	13,14,18,19	1980	656	W1
			15,17	1980	4,598	W1
			16	1980	0	W1
Building 800 H	86.96% Good	1	20,21,26,27	1975	642	W1
			22,25	1975	5,112	W1
			23	1975	0	W1
			28	1975	1,150	W1
Play Shed	75.67% Fair	1	CP	1974	4,000	W1
Portable 901/902	-	1	Area 1	2000	1,792	W1
Portable 903/904	-	1	Area 1	2001	1,792	W1
Portable 905/906	-	1	Area 1	2000	1,792	W1
Portable 907/908	-	1	Area 1	2000	1,792	W1
Portable 909/910	-	1	Area 1	1980	1,782	W1
Portable 911/912	-	1	Area 1	2003	1,792	W1
Portable 913/914	-	1	Area 1	2003	1,792	W1

Hockinson Pre-Disaster Mitigation Summary						
Campus/ Building	Building Condition	Floors	Building Area	Built	SqFt	Structural Sys
Portable One	-	1	P-1	1980	0	W1
Hockinson High School						
Athletic Storage Building	97.87% Excellent	1	Area 1	2003	850	RM1L
Field Concession & Press Booth	90.00% Good	3	Coaches Booth 2nd Fl	2005	317	
			Concession 1st Flr	2005	317	
			Press Booth 3rd Flr	2005	317	
Main Building	82.55% Fair	2	2nd Flr U1,12,13	2003	9,404	RM1L
			2nd Flr U1,7-11,14	2003	14,022	RM1L
			2nd Flr U2-6	2003	18,604	RM1L
			Main Flr M1,2,3,4,5,	2003	29,456	RM1L
			Main Flr M7,8,10-14,	2003	42,477	RM1L
			Main Flr M9,15,16&20	2003	21,321	RM1L
Northwest Baseball Field Storage and Dugout	85.59% Good	1	Dugout area 1	2005	236	
			Storage area 2	2005	53	
South Baseball Field Storage and Dugout	90.00% Good	1	Dugout area 1	2005	283	
			Storage area 2	2005	187	
Hockinson Middle School (old)						
Building A	75.16% Fair	1	1st flr A-1a,2	1953	7,808	W1
			1st flr A-1b	2001	1,552	W1
			1st flr A-3,4	1953	12,761	W1
			1st flr A-5	1963	4,970	W1
Building B	80.95% Fair	1	A-6-10	1989	8,935	W1
Building C	77.73% Fair	1	1st flr A 11	2001	3,315	W1
			1st flr A 12-15	1989	13,387	W2
Building D	88.11% Good	1	A 16,17	2001	3,360	W1
Covered Playshed	87.93% Good	1	A 18	2001	4,000	W1
Portable 113/114	-	1	Area 1	2003	1,792	W1
Portable 116/117	-	1	Area 1	2001	1,792	W1
Portable 222/223	-	1	Area 1	1991	1,782	W1
Portable 224/225	-	1	Area 1	2001	1,792	W1
District Maintenance Shop						
District Maintenance	90.00% Good	2	Administration 2	2001	1,059	S3
			Covered storage 3	2001	1,323	S3
			Mezzanine 4	2001	1,059	S3
			Service & storage 1	2001	4,047	S3
School District Administration						
School District Administration	90.00% Good	1	Area 1	2001	1,885	W1
			Area 2	2001	1,885	W1

Recent Construction:

In 2014-2015 school year the District started on several capital facility projects. The High School installed additional athletic fields, new bleachers, a new field house building for sports, and a high school band room addition to the current building. In 2015-2016 school year the District began construction of the replacement Middle School which is expected to be opened for the 2017-2018 school year.

Early renderings of the replacement Middle School.

